



## 3 Airbag

### 3.1 Overview - installation locations

#### 1 - Airbag unit, driver side

- ❑ Removing ➔ [page 36](#)

#### 2 - Airbag warning lamp (K75)

#### 3 - Airbag unit, front passenger side

- ❑ Removing ➔ [page 41](#)
- ❑ Adapting components (locking and activating) ➔ [page 55](#)

#### 4 - Diagnosis connector

- ❑ Behind left footwell compartment

#### 5 - Side airbag, front passenger side

- ❑ Removing ➔ [page 46](#)
- ❑ Adapting components (locking and activating) ➔ [page 55](#)

#### 6 - Side airbag crash sensor, front passenger side

- ❑ Removing ➔ [page 50](#)

#### 7 - Side airbag crash sensor, driver side

- ❑ Removing ➔ [page 50](#)

#### 8 - Side airbag, driver side

- ❑ Removing ➔ [page 46](#)
- ❑ Adapting components (locking and activating) ➔ [page 55](#)

#### 9 - Airbag control unit (J234)

- ❑ Removing ➔ [page 45](#)
- ❑ Adapting components (coding) ➔ [page 55](#)

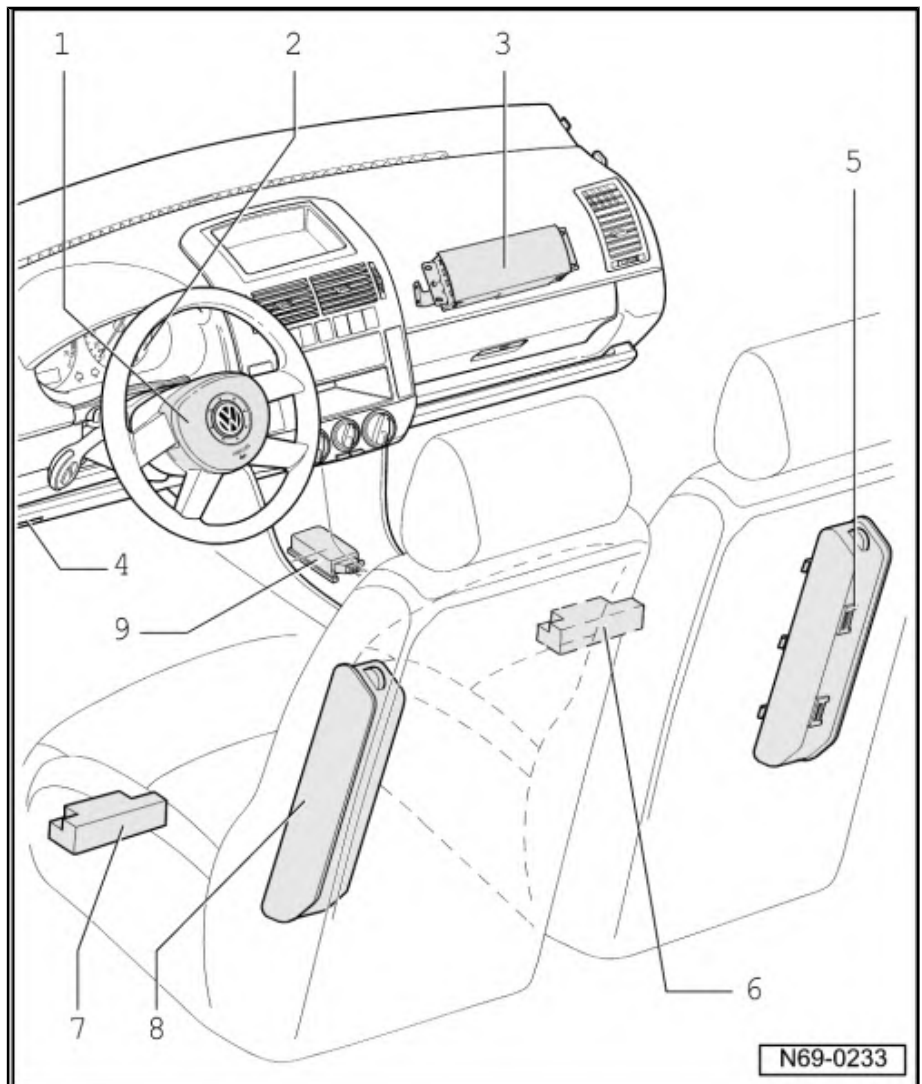

### 3.2 Safety precautions when working on airbag

- ◆ Testing, removing, installing and repair work may only be performed by qualified personnel.
- ◆ Before working on the airbag system, disconnect the battery earth strap. No waiting time is necessary after disconnecting the battery. When the airbag system is connected to a voltage source, no person must be present inside the vehicle.
- ◆ Before picking up (touching) the airbag unit, the mechanic must electrostatically discharge him/herself. This can be done by touching a suitable metal part, for example, a water pipe, a heater pipe or a metal frame.



- ◆ Airbag units must be installed immediately after they are removed from their packaging.
- ◆ If work is interrupted, the airbag unit must be replaced in its packaging.
- ◆ Leaving airbag unit unattended is prohibited.
- ◆ Removed airbag units must be stored with the padded side facing up.
- ◆ Airbag units which have been dropped onto a hard surface or show signs of damage must not be installed in the vehicle.
- ◆ Storage and transportation are subject to laws governing explosive substances.
- ◆ Only genuine VW seat covers which have been approved for side airbags (identifiable by the airbag emblem) must be installed.
- ◆ Seat protectors must be compatible with airbags.
- ◆ When backrest cover is installed, seam must be straight in vicinity of side airbag.
- ◆ All padding clips must be renewed.
- ◆ Always use genuine VW padding clips.
- ◆ If cover is damaged - tears, burn holes and so on - in the vicinity of the side airbag, always renew cover.

### 3.3 Additional safety precautions for the curtain airbag

- ◆ Always renew damaged pillar trim; never repair.
- ◆ Curtain airbags must not be kinked or twisted.
- ◆ After bodywork repairs in the vicinity of the curtain airbag, check area for weld spray droplets, deformations and abrasive areas (compare with opposite side if necessary).
- ◆ If an ignited curtain airbag is renewed, generally the moulded headlining, door seals with beading, curtain airbag guides, grab handle brackets, trim on the A, B and C-pillars and, if installed, D-pillar trim must also be renewed. If damaged, (rear) interior reading lights, roof grab handles and roof frame trim must be renewed.

### 3.4 Disposal of airbag units

- ◆ Non-triggered airbag units must, according to national legislation, be disposed of correctly in the original packaging. If in doubt, contact your distribution centre or importer for details.
- ◆ Used airbag units can be disposed of via commercial waste disposal.

### 3.5 Deactivating the airbag



#### WARNING

*The prerequisites for deactivating one or more airbag units have been published in the "Technical Service Handbook".*

In the "Technical Service Handbook 2", the "Procedure ID" or the "Technical solution number" for the deactivation of airbag units is "2000987".

ElsaWin



- Technical solution
- Technical service handbook
- Technical solutions
- Vehicle electrics
- Function
- Passenger protection
- Deactivation of airbag units
- Systems

### 3.6 Renewing airbag units following an accident

#### 3.6.1 Accident involving triggering of airbag

Following the renewal of airbag units or the airbag control unit, the labels (only tear-off strips) of the new components must be stuck onto the "Registry note 2 for Airbag Systems". For registration, the "Registry note 2 for Airbag Systems" must be sent on to the responsible distribution centre or importer.

The "Registry note 2 for Airbag Systems" can be printed out of the "Technical Service Handbook":

ElsaWin

- Technical solution
- Technical service handbook
- Technical solutions
- Vehicle electrics
- Function
- Passenger protection
- Deactivation of airbag units
- Systems

In the "Technical Service Handbook 2", the "Procedure ID" or the "Technical solution number" for this procedure is "2000987".

**As a matter of rule, the following components will have to be renewed following an accident where the airbag has been triggered:**

- ◆ All triggered airbag units with control units and sensors.
- ◆ Supports for front passenger module if front passenger airbag was triggered.
- ◆ Coil connector with slip ring, when driver airbag has triggered.
- ◆ All seat belts with triggered belt tensioners.
- ◆ In addition, the following must also be replaced if necessary (visual check): all damaged components.

#### 3.6.2 Accident not involving triggering of airbag

- ◆ If the airbag warning lamp (K 75) does not indicate a fault, it is not necessary to replace the airbag components. The seat belts should be checked separately.



## 3.7 Removing and installing driver airbag unit

### 3.7.1 Assembly overview

- 1 - Steering wheel
- 2 - Connector
- 3 - Airbag unit

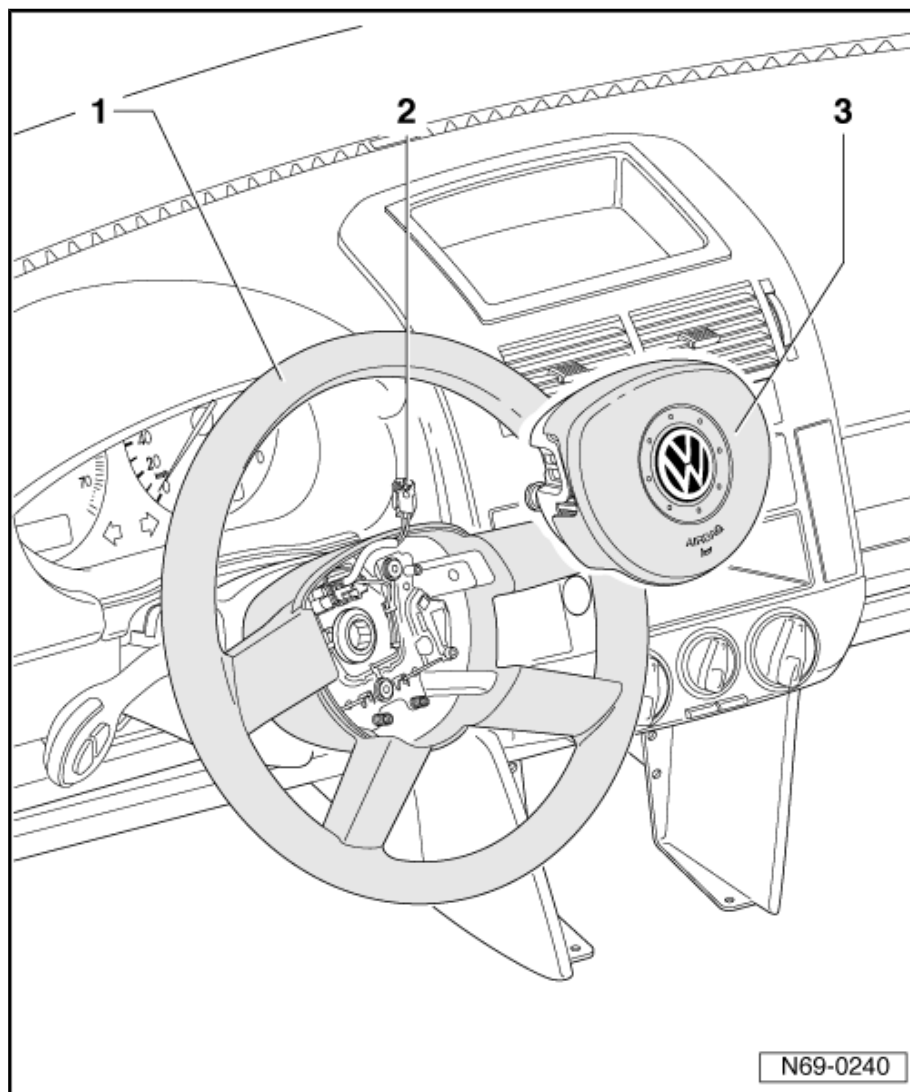

### 3.7.2 Removing



#### WARNING

*Refer to safety precautions when working on the airbag  
⇒ [page 33](#).*

- Disconnect vehicle battery ⇒ Electrical system; Rep. Gr. 27 ; Battery .



- Turn steering wheel until horizontal spokes are vertical.
- Pull out steering column completely and lock in lowest position.
- Insert a screwdriver about 5 mm wide in hole on back of steering wheel hub.
- Press screwdriver in direction of arrow (airbag unit will be released and rises slightly out of steering wheel hub).
- Turn steering wheel back 180° and release second catch.
- Carefully pull airbag unit slightly out of steering wheel.

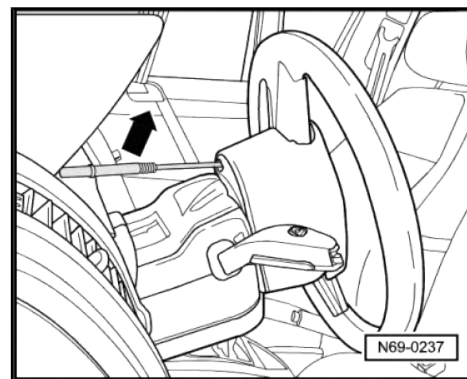

#### WARNING

*Electrostatic discharges may result in unintentional triggering of airbag. Therefore, the mechanic must electrostatically discharge him/herself before disconnecting the igniter and earth wires. This can be done by briefly touching the body or striker plate of the door.*

- Using a screwdriver, carefully lever out catch -1- of connector -2-.
- Separate connector -1- from airbag unit and remove airbag unit.

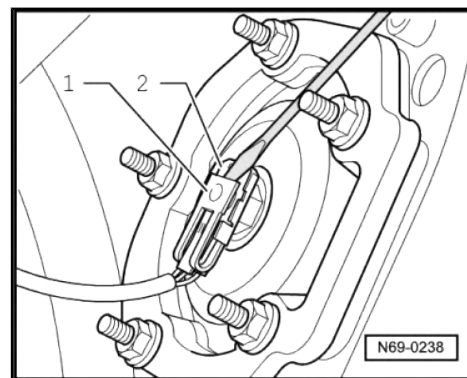

### 3.7.3 Installing

- Join connector -2- to airbag unit -3- and engage latch.
- Set airbag unit -3- in installation position. Press in airbag unit -3- on left and right sides until it can be heard to engage.
- Check that airbag unit is engaged on left and right sides in steering wheel.

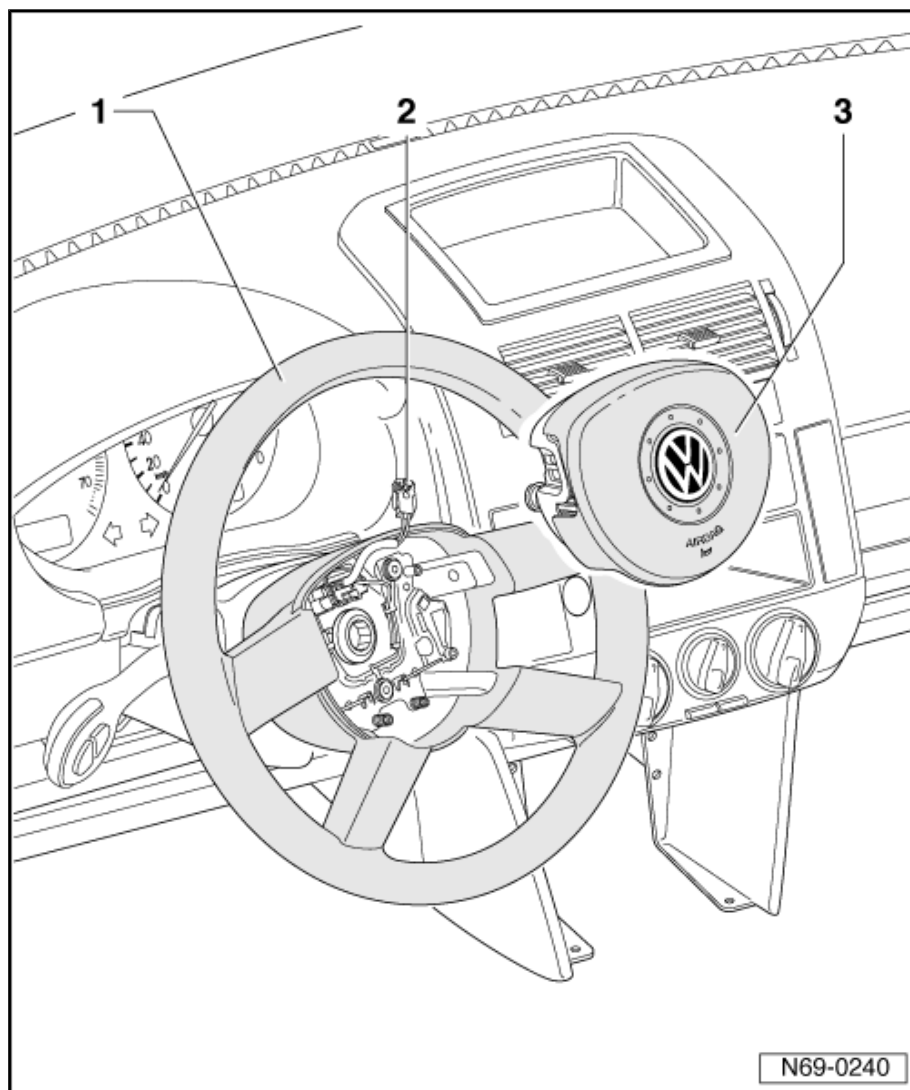

- Switch ignition on.



**WARNING**

*Ensure that nobody is in the vehicle.*

- Connect vehicle battery ⇒ Electrical system; Rep. Gr. 27 ;  
Battery .



## 3.8 Removing and installing steering wheel

### 3.8.1 Assembly overview

1 - Steering wheel

2 - Connector

3 - Connector

4 - Airbag unit

5 - Bolt

- ☐ 55 Nm
- ☐ Treated with locking compound
- ☐ Can be used up to 5 times
- ☐ Mark with a centre punch after each assembly

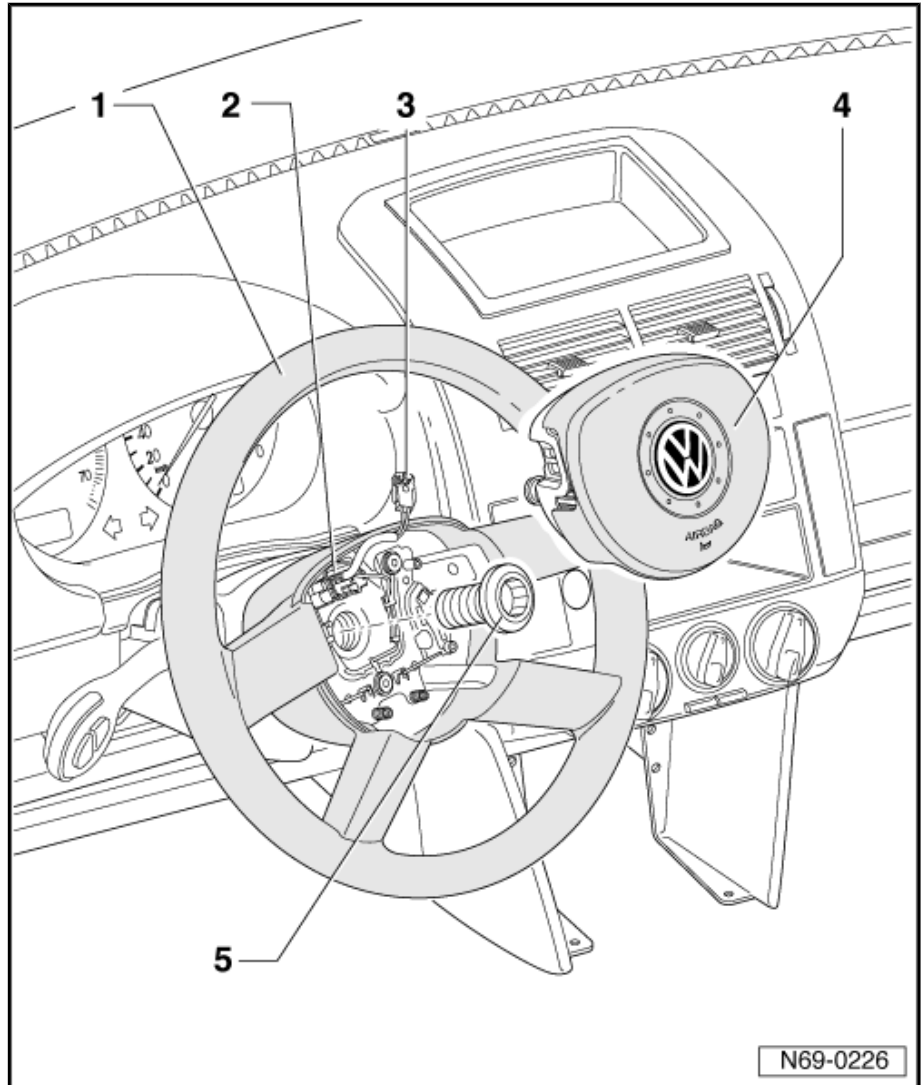

### 3.8.2 Removing

- Remove driver airbag unit ⇒ [page 36](#) .
- Turn wheels to straight-ahead position.
- Unplug connector -2- to return spring.
- Remove bolt -5-.
- Remove steering wheel -1-. Return spring remains on steering column switch.

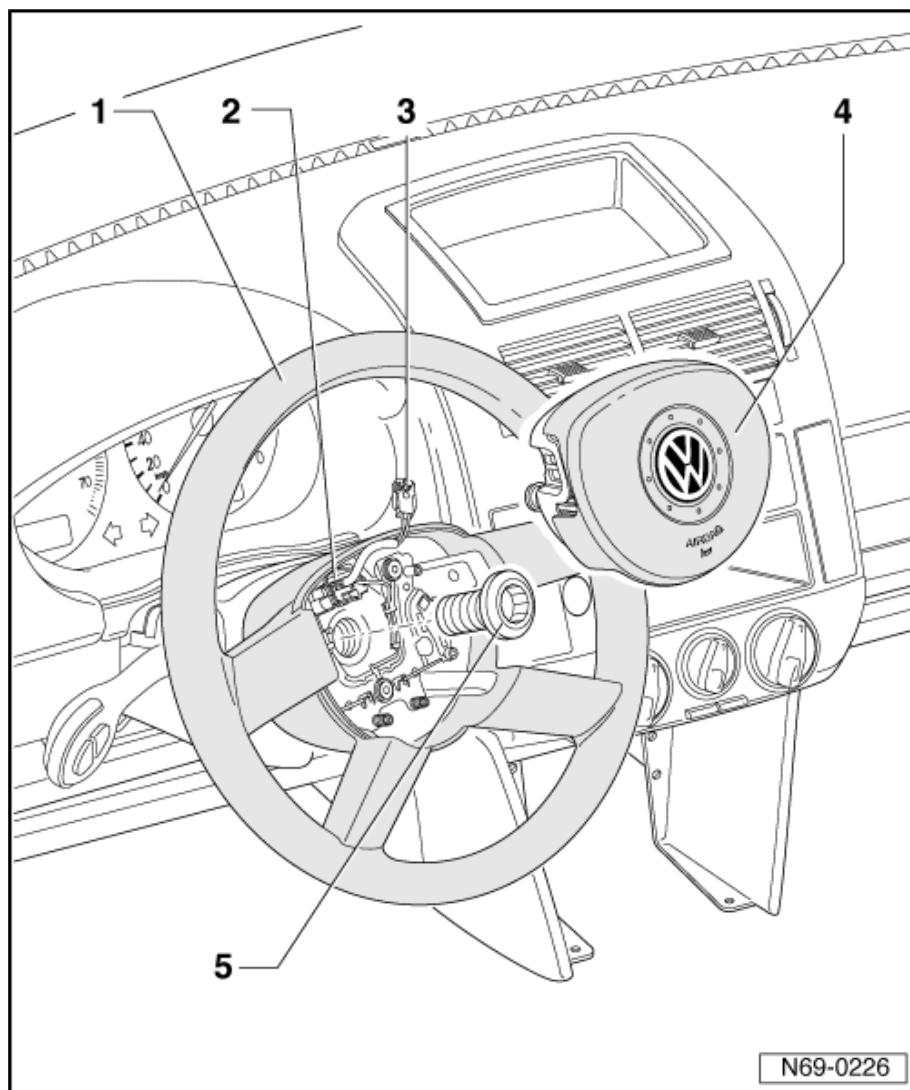

### 3.8.3 Installing

- Set steering wheel on so that lines on steering wheel hub -2- and punch marks on steering column -3- align.

Steering columns supplied as spare parts have no punch marks.

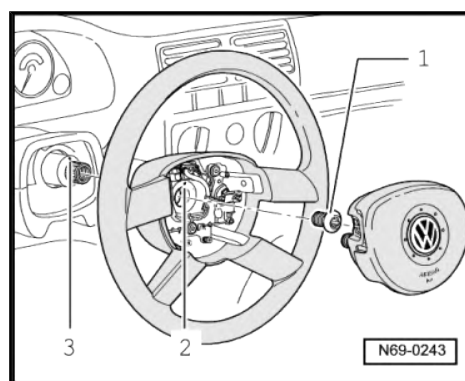

### 3.9 Removing and installing return spring with slip ring

Depending on model, the airbag coil connector and return spring with slip ring -F 138- is part of the steering column switch.

⇒ Electrical system; Rep. Gr. 94 ; Steering column switch





## 3.10 Removing and installing front passenger airbag unit

### 3.10.1 Removing



#### WARNING

*Refer to safety precautions when working on the airbag  
⇒ [page 33](#).*

- Disconnect vehicle battery ⇒ Electrical system; Rep. Gr. 27 ; Battery .
- Remove glove compartment ⇒ [page 10](#) .



#### WARNING

*Electrostatic discharges may result in unintentional triggering of airbag. Therefore, the mechanic must electrostatically discharge him/herself before disconnecting the igniter and earth wires. This can be done by briefly touching the body or striker plate of the door.*

- Disconnect wiring harness from front passenger airbag.
- Remove bolts -1- (6 Nm).



#### Note

*For greater clarity, a section of the dash panel and the front passenger airbag are shown removed.*

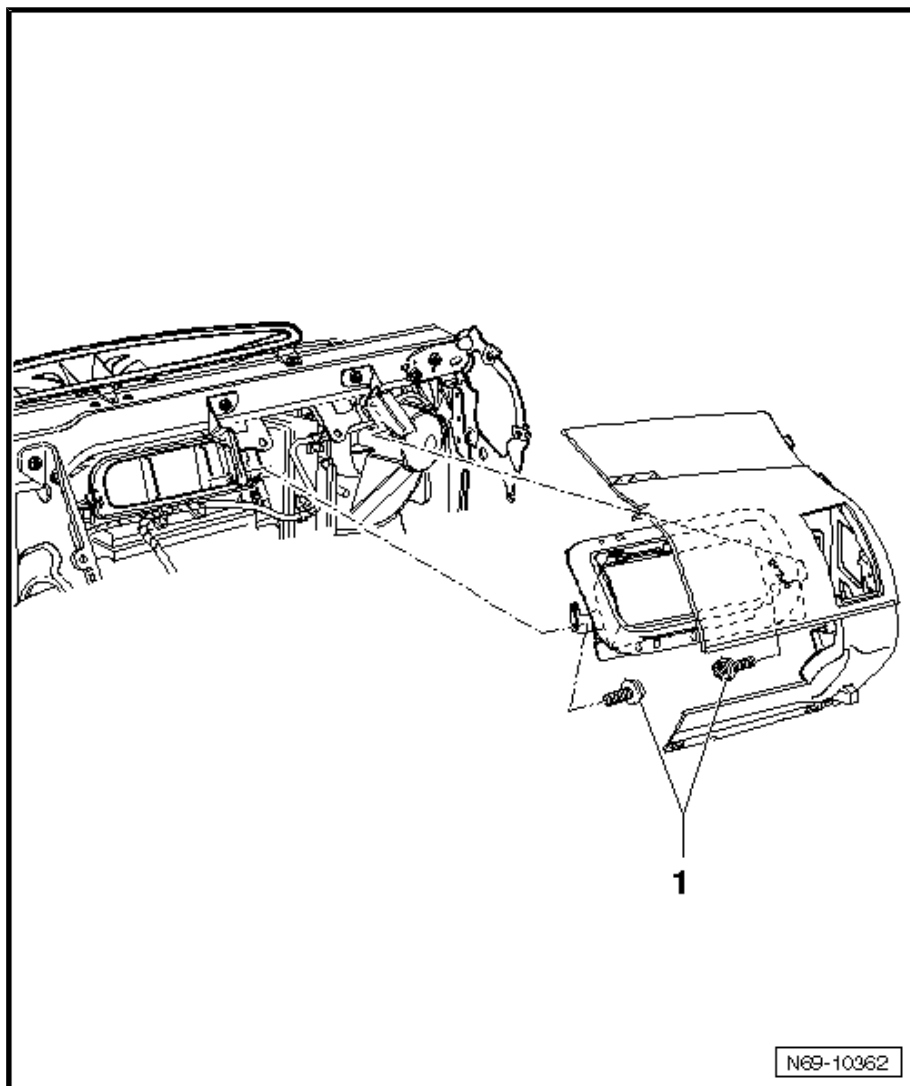

- Remove bolts -1- and -2- (10 Nm).



**Note**

*The bolts are in front, in direction of travel.*

- Remove bolts -3- and -4- (10 Nm).
- Remove front passenger airbag unit -1- from dash panel.

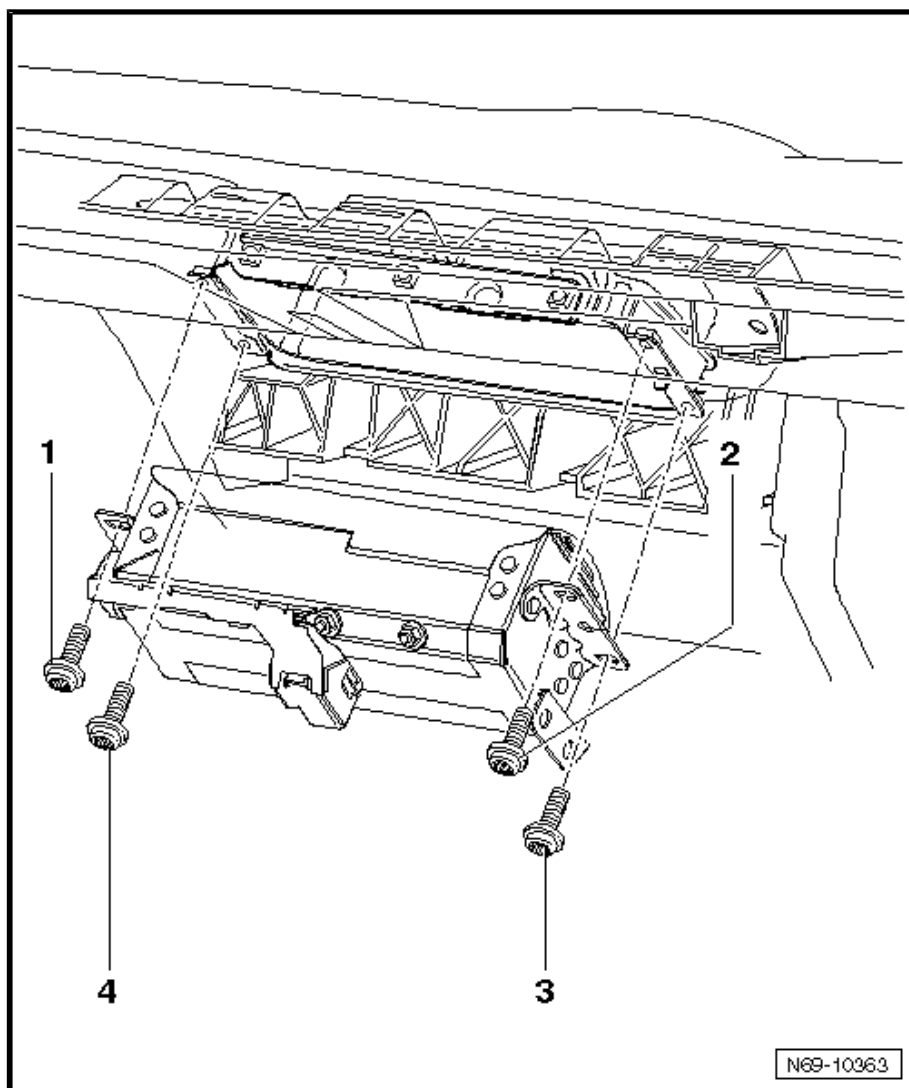

### 3.10.2 Installing

- Installation is carried out in reverse order of removal.

Check whether an additional earth cable needs to be fitted in the vehicle:



#### WARNING

*If a front passenger airbag is renewed, an additional earth cable may have to be fitted to the vehicle*

- Check whether an earth cable -2- is attached to the front passenger airbag housing -1-.

If the front passenger airbag does not have an earth cable, then fit an additional earth cable in the vehicle.

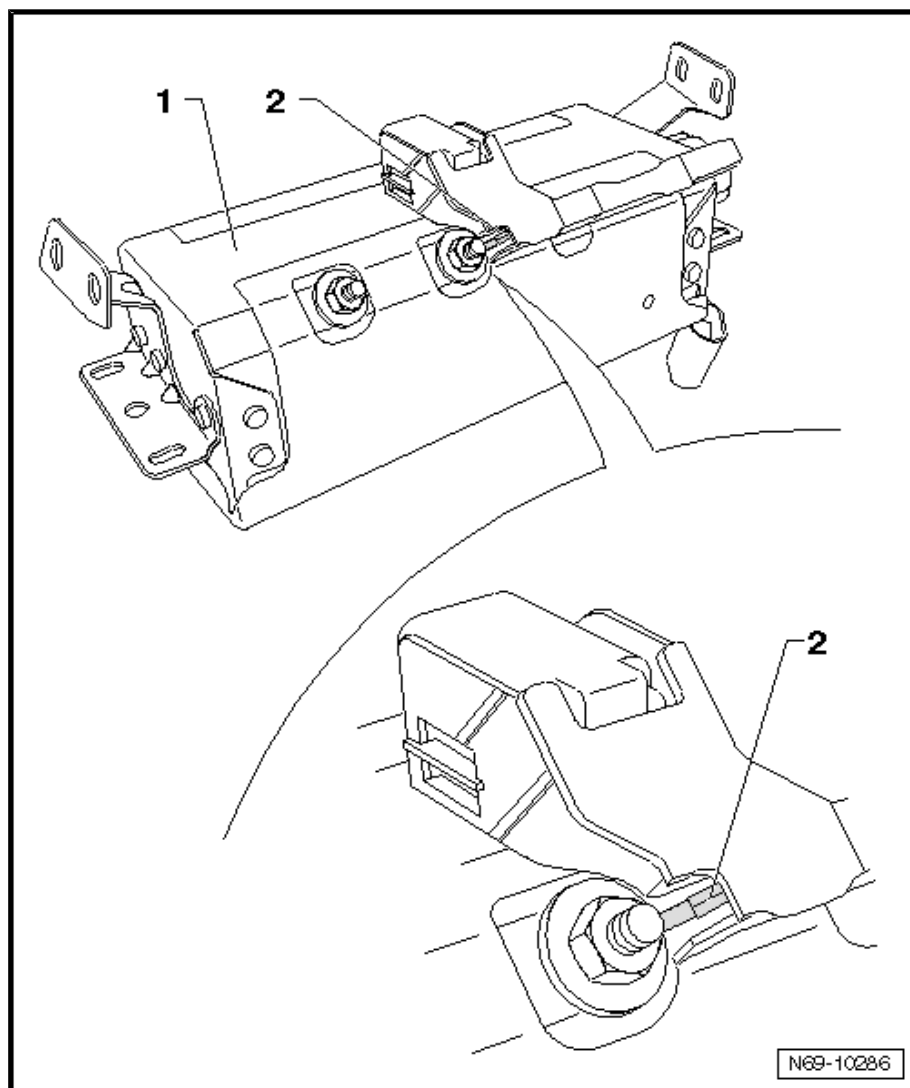

**Routing an additional earth wire in the vehicle if the front passenger airbag does not have an earth cable**



**Note**

*For the following work use a cable (wire cross section 1 mm, length 600 mm) from the Wiring harness repair set -VAS 1978- or Wiring harness repair set -VAS 1978A- .*

- Secure one end of the earth wire with the bolt -1- on the left side of the front passenger airbag.
- Route earth wire properly up to the earth pin -2- behind the airbag control unit.



**Note**

*If needed, extend the earth wire with the appropriate materials from Wiring harness repair set -VAS 1978- or Wiring harness repair set -VAS 1978A- .*

- Connect the other end of the earth wire to the earth pin.

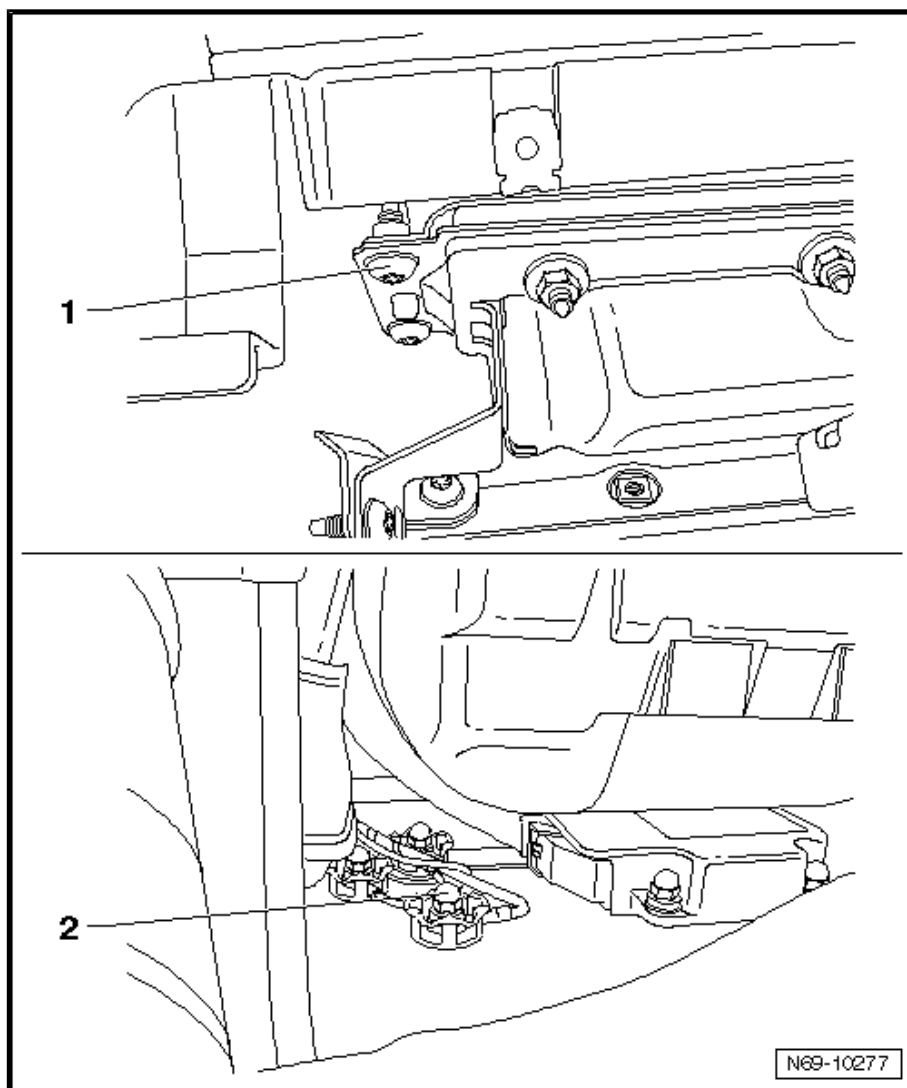

- Switch ignition on.



**WARNING**

*Ensure that nobody is in the vehicle.*

- Connect vehicle battery ⇒ Electrical system; Rep. Gr. 27 ; Battery .

### 3.11 Removing and installing airbag control unit (J234)



**WARNING**

*Refer to safety precautions when working on the airbag  
⇒ [page 33](#) .*

- Disconnect vehicle battery ⇒ Electrical system; Rep. Gr. 27 ; Battery .
- Remove upper part of centre console ⇒ [page 6](#) .



- Remove lower part of centre console ➔ [page 8](#) .
  - If necessary, cut into floor covering and insulation mat near control unit bracket.
  - Remove bolt -2-.
  - Remove air duct -1-.
- 
- Move bar -2- in direction of arrow and pull connector -3- out of the control unit -1-.
  - Unscrew cap nuts -4- and pull control unit off studs.
  - Specified torque: cap nuts -4- = 6.5 Nm.
  - Installation is carried out in reverse order of removal.
  - Switch ignition on.

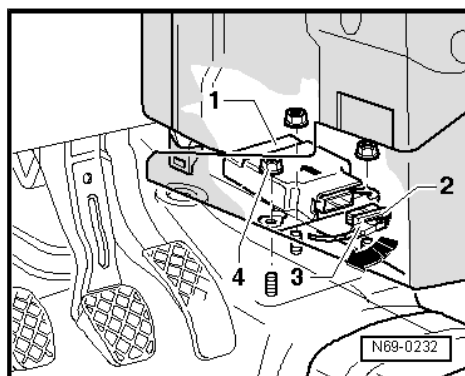
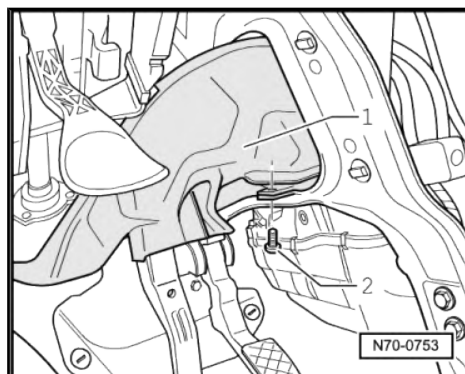

#### WARNING

*Ensure that nobody is in the vehicle.*

- Connect vehicle battery ➔ Electrical system; Rep. Gr. 27 ; Battery .
- If control unit is to be renewed, it must be coded. Adapting components (coding) ➔ [page 55](#) .

### 3.12 Removing and installing driver and front passenger side airbag



#### Note

*Removal and installation are described for the left side of vehicle. Follow same instructions for the right side as appropriate.*

#### 3.12.1 Removing



#### WARNING

*Refer to safety precautions when working on the airbag ➔ [page 33](#) .*

- Disconnect vehicle battery ➔ Electrical system; Rep. Gr. 27 ; Battery .
- Remove driver or front passenger seat ➔ [page 123](#) .
- Remove seat backrest ➔ [page 131](#) .
- Remove backrest (with parallel height adjustment) ➔ [page 131](#) .
- Loosen backrest cover in vicinity of airbag -1-.



- Guide connector -3- through opening in backrest padding.
- Remove bolts -2-.
- Specified torque: bolts -2- = 7 Nm.
- Pull side airbag -1- out from backrest frame -4-.

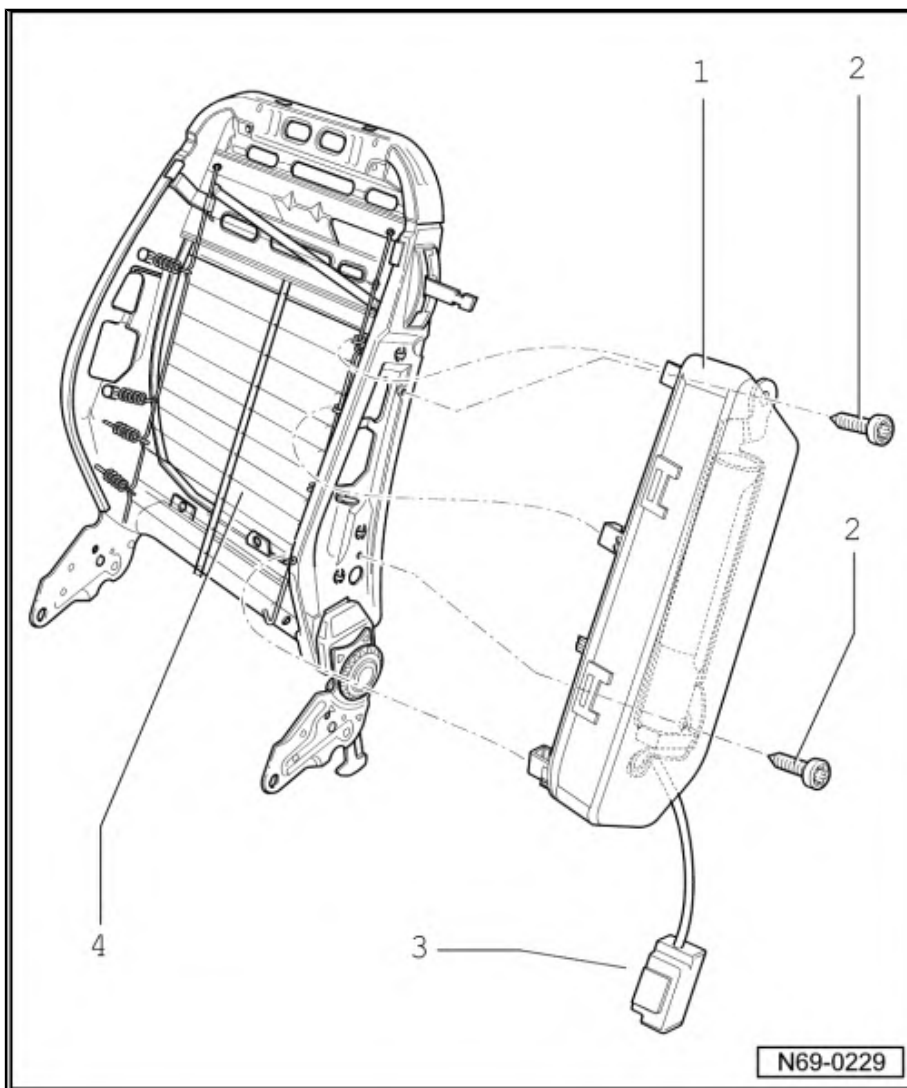

### 3.12.2 Installing

- Installation is carried out in reverse order of removal.
- Switch ignition on.



#### **WARNING**

*Ensure that nobody is in the vehicle.*

- Connect vehicle battery ⇒ Electrical system; Rep. Gr. 27 ;  
Battery .



### 3.13 Removing and installing curtain airbag on driver and passenger side



#### Note

- ♦ *Removal and installation of curtain airbag is described for the right vehicle side. Follow same instructions for the left side as appropriate.*
- ♦ *Removal and installation of curtain airbag is described for the 2-door model. Removal and installation for the 2-door can be derived from this.*

#### 3.13.1 Removing



#### WARNING

*Refer to safety precautions when working on the airbag  
⇒ [page 33](#) .*

- Disconnect vehicle battery ⇒ Electrical system; Rep. Gr. 27 ; Battery .
- Switch off ignition.
- Remove upper A-pillar trims ⇒ [page 81](#) .
- Remove upper B-pillar trims. Seat belt end anchors need not be removed ⇒ [page 86](#) .
- Unclip upper C-pillar trim from mountings in body in transition area to moulded headliner.
- ♦ 2-door ⇒ [page 92](#)
- ♦ 4-door ⇒ [page 90](#)
- Remove moulded headlining:
- ♦ Vehicles without sunroof ⇒ [page 111](#) .
- ♦ Vehicles with sunroof ⇒ [page 115](#) .



#### WARNING

*Electrostatic discharges may result in unintentional triggering of airbag. Therefore, the mechanic must electrostatically discharge him/herself before disconnecting the igniter and earth wires. This can be done by briefly touching the body or striker plate of the door.*

- Separate wiring harness from curtain airbag.
- Remove nut -1- (4.5 Nm).
- Remove the three bolts -2- (4.5 Nm).
- Remove bolt -3- (4.5 Nm).
- Remove nut -4- (4.5 Nm).
- Remove the two bolts -5- (4.5 Nm).
- Separate curtain airbag from mountings -6- in vicinity of B-pillar.





- Separate curtain airbag from mountings -7- in vicinity of C-pillar.
- Separate curtain airbag from mountings -8- in vicinity of roof cross member.

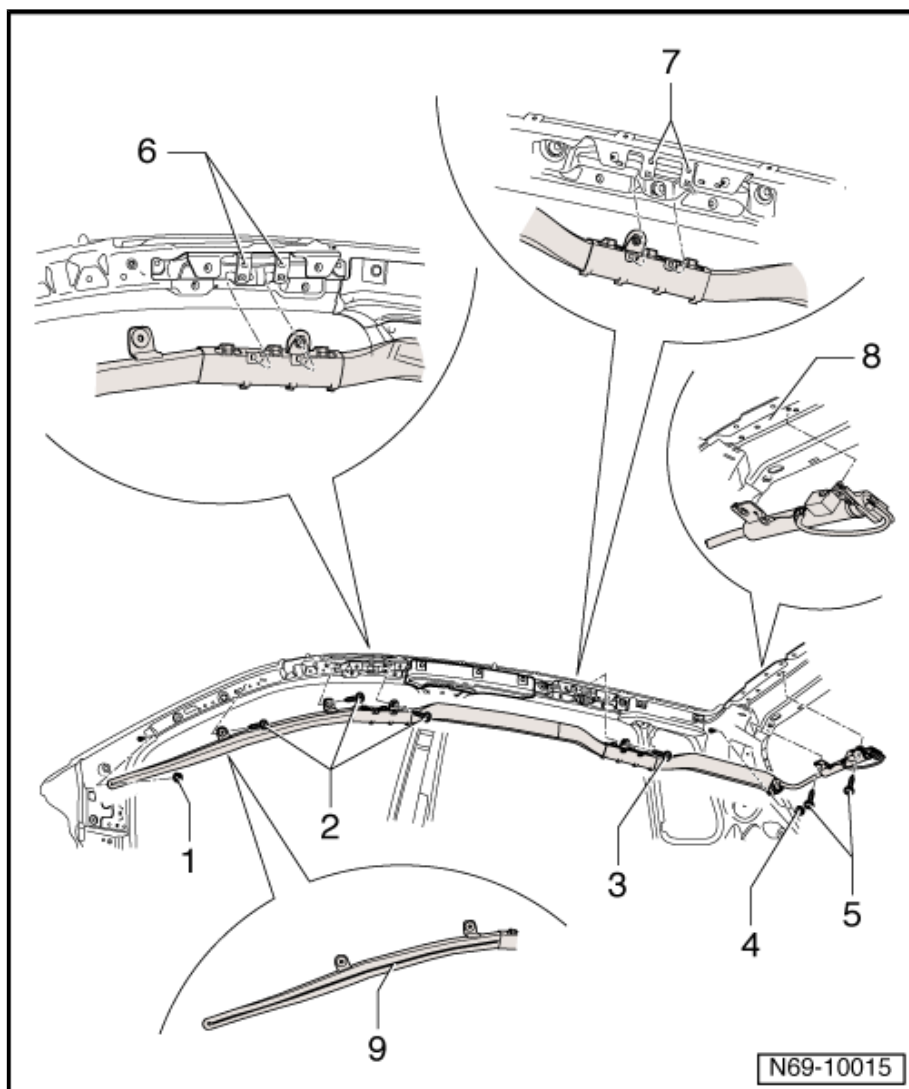

- Remove curtain airbag from vehicle through rear lid.

### 3.13.2 Installing

- Installation is carried out in reverse order of removal.



#### Note

*During installation, identification -9- must face forwards. Reversing front and back is not permissible.*

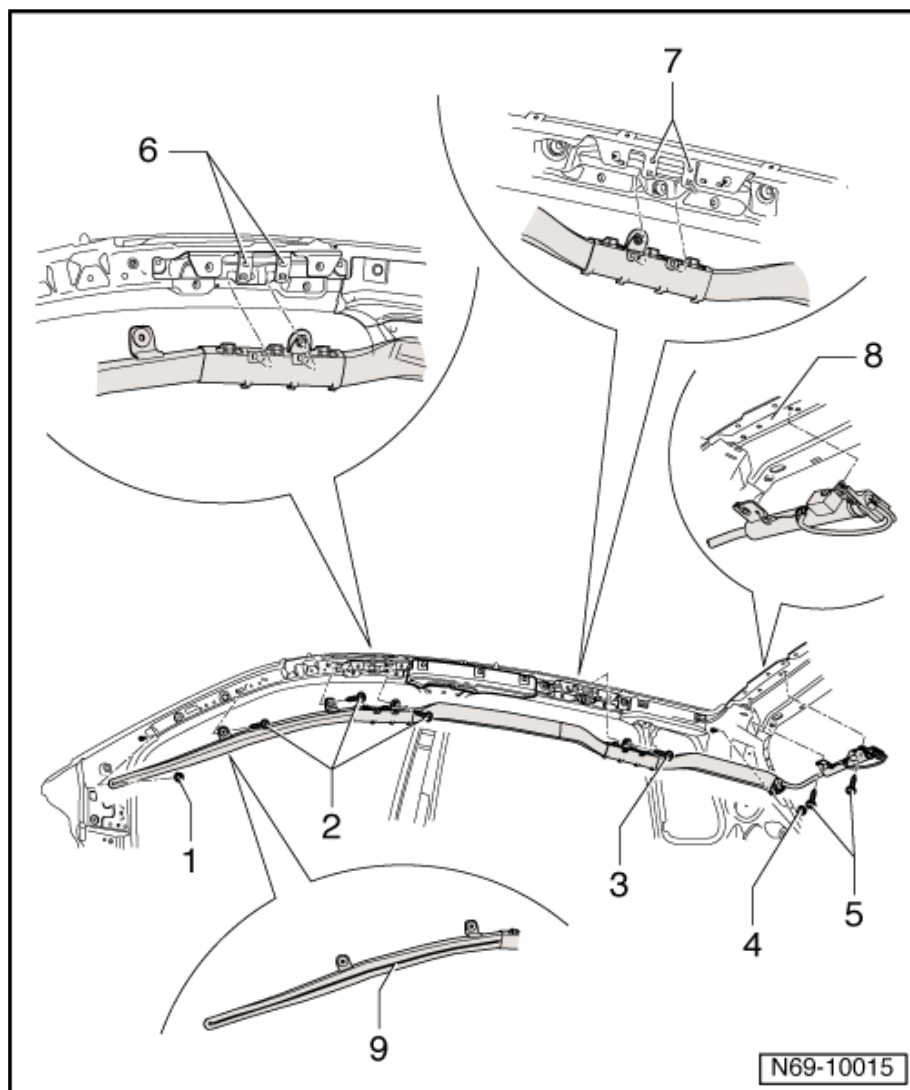

- Switch ignition on.



**WARNING**

*Ensure that nobody is in the vehicle.*

- Connect vehicle battery ⇒ Electrical system; Rep. Gr. 27 ; Battery .

### 3.14 Removing and installing crash sensor for side airbag for driver or front passenger

#### 3.14.1 Removing



**WARNING**

*Refer to safety precautions when working on the airbag  
⇒ [page 33](#) .*



- Disconnect vehicle battery ⇒ Electrical system; Rep. Gr. 27 ; Battery .
- Remove driver or front passenger seat ⇒ [page 123](#) .
- Remove sill panel moulding (4-door) ⇒ [page 12](#) .
- Remove sill panel moulding (2-door) ⇒ [page 13](#) .
- Separate floor covering -4- in vicinity of crash sensor -1-.
- Disconnect connector -2-.
- Remove bolts -3-.
- Remove crash sensor -1-.

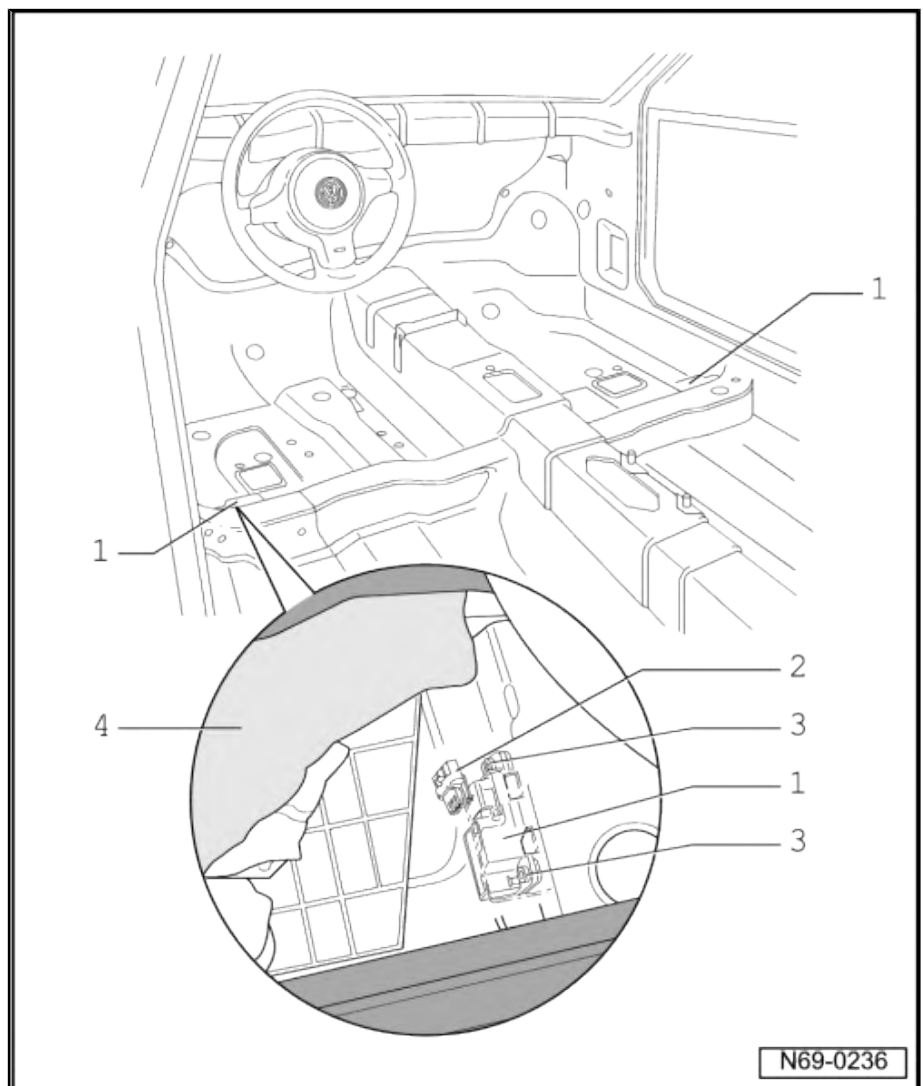

### 3.14.2 Installing

- Installation is carried out in reverse order of removal.
- Switch ignition on.



#### **WARNING**

*Ensure that nobody is in the vehicle.*



- Connect vehicle battery ⇒ Electrical system; Rep. Gr. 27 ; Battery .

### 3.15 Removing and installing crash sensor for right curtain airbag

#### 3.15.1 Removing



#### WARNING

*Refer to safety precautions when working on the airbag  
⇒ [page 33](#) .*

- Disconnect vehicle battery ⇒ Electrical system; Rep. Gr. 27 ; Battery .
- Fold bench seat and backrest forwards.
- Loosen lock carrier cover in transition area to support for luggage compartment cover.
- Remove support for luggage compartment cover  
⇒ [page 100](#) .
- Loosen luggage side compartment trim on right in upper section of body.
- Remove the two bolts -1- (9 Nm).
- Disconnect wiring harness -2- from crash sensor -3-.

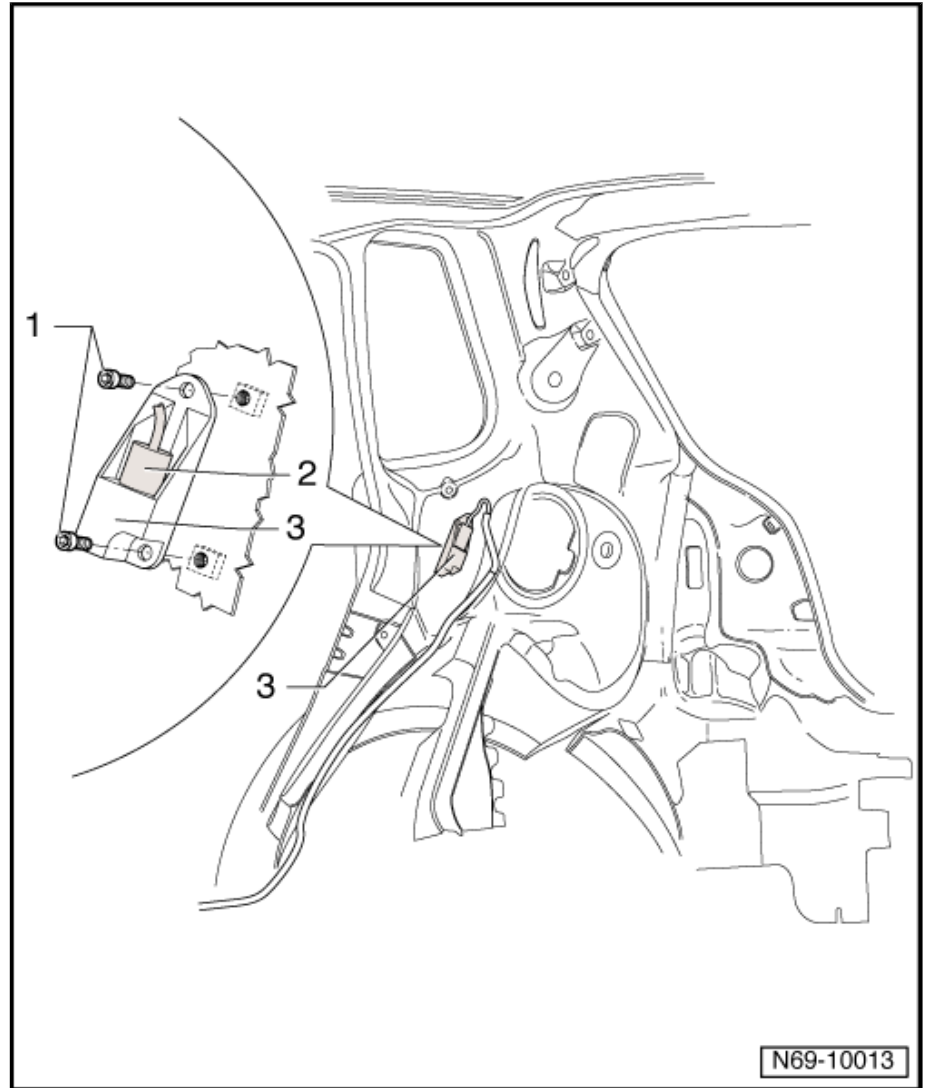

### 3.15.2 Installing

- Installation is carried out in reverse order of removal.
- Switch ignition on.



#### **WARNING**

*Ensure that nobody is in the vehicle.*

- Connect vehicle battery ⇒ Electrical system; Rep. Gr. 27 ; Battery .



## 3.16 Removing and installing crash sensor for left curtain airbag

### 3.16.1 Removing



#### WARNING

*Refer to safety precautions when working on the airbag  
⇒ [page 33](#).*

- Disconnect vehicle battery ⇒ Electrical system; Rep. Gr. 27 ; Battery .
- Fold bench seat and backrest forwards.
- Loosen luggage side compartment trim on left in upper section of body.
- Remove the two bolts -1- (9 Nm).
- Disconnect wiring harness -2- from crash sensor -3-.

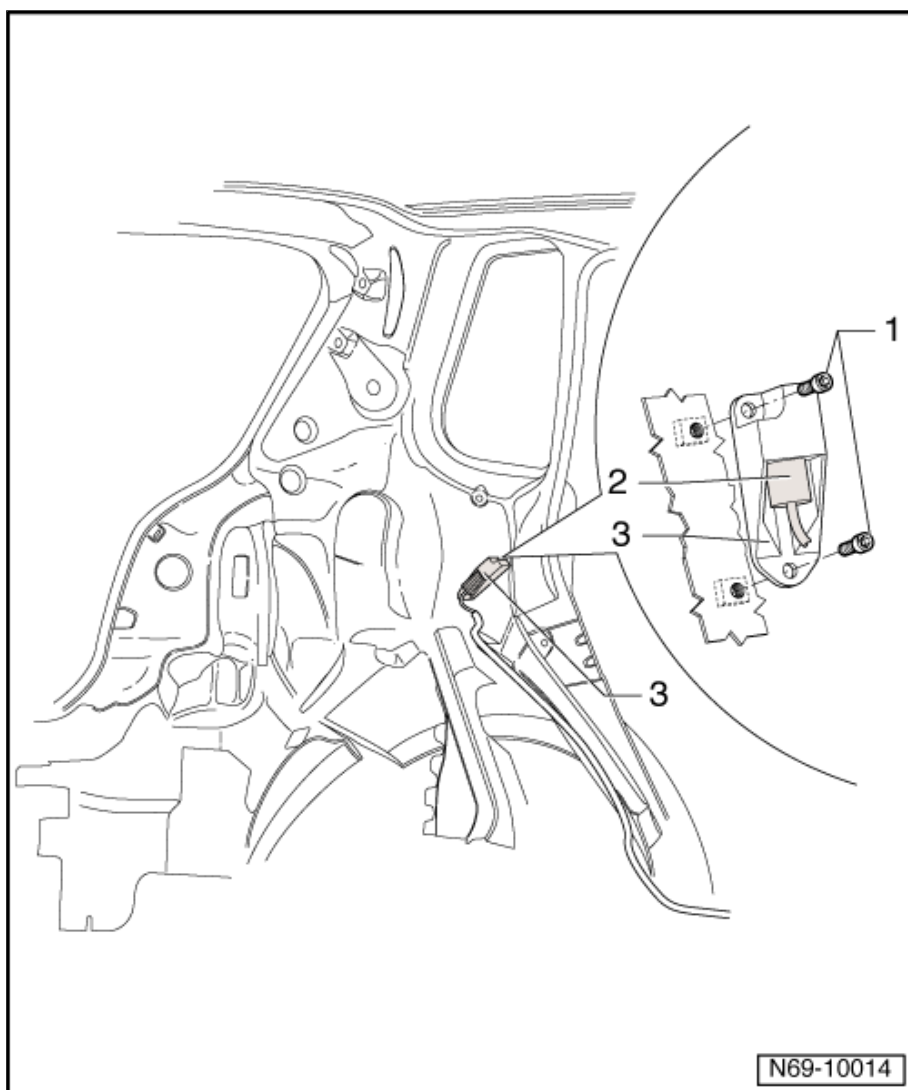



### 3.16.2 Installing

- Installation is carried out in reverse order of removal.
- Switch ignition on.



#### **WARNING**

*Ensure that nobody is in the vehicle.*

- Connect vehicle battery ⇒ Electrical system; Rep. Gr. 27 ; Battery .

### 3.17 Adapting components

#### 3.17.1 Required special tools, workshop equipment, test and measuring devices and auxiliary items

- ◆ Vehicle diagnosis, testing and information system -VAS 5051-
- ◆ Diagnosis lead -VAS 5051/1- or -VAS 5051/3-

Select “guided fault finding” in vehicle diagnosis, testing and information system -VAS 5051- .

Once all control units have been read:

- Press “GoTo” button.
- Select “Function/component selection”.
- Select “Body”.
- “General body repairs”
- Select “01 Systems capable of self-diagnosis”
- Select “Airbag”.
- Select “Functions”.
- Select “Action”.

